

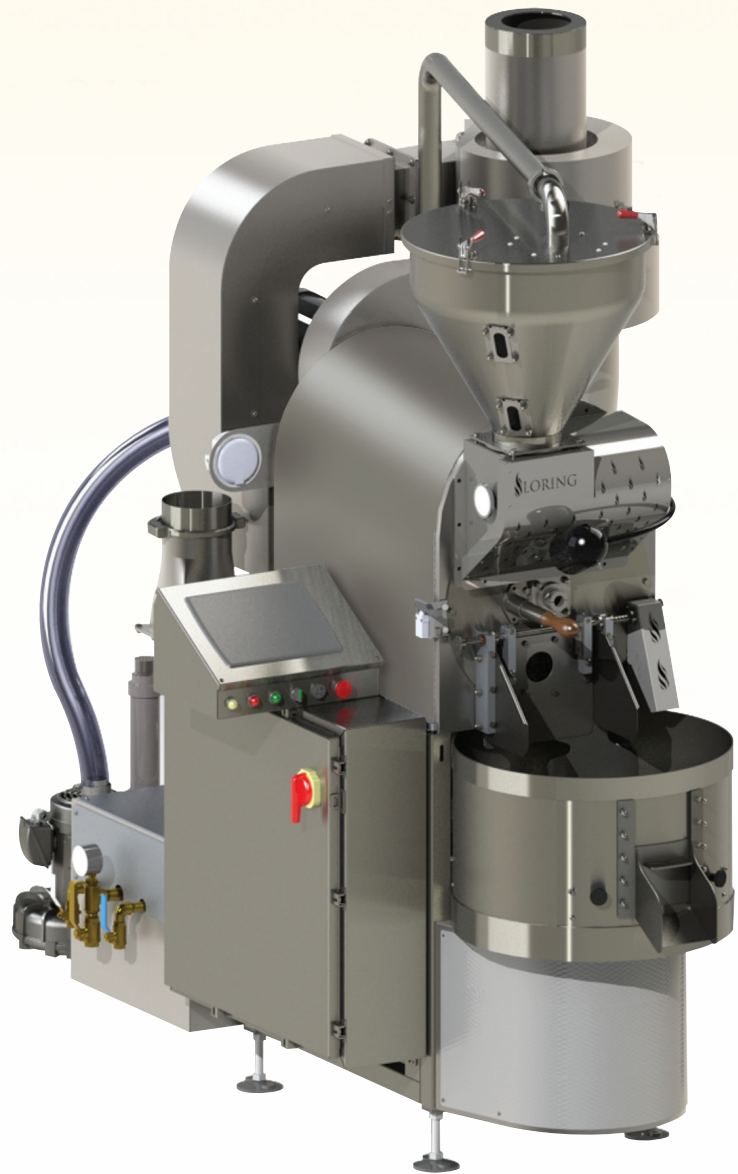

LORING™ S15 FALCON™

Convection Drum Roaster with Paddle Stirring

- Benefits Include:
 - » Very low oxygen roast atmosphere protects natural flavors
 - » Smokeless, odorless exhaust during roasting*
 - » High-speed cooling tray and air cool system
 - » Profile Roasting: Unlimited number of profiles can be captured during roasting or manually created; precise tracking of profile curve
- Capacity: 15 kg green coffee beans per batch
- Controls: Touch screen and PLC provide precise operation of burner and fan speeds
- Communications: Download roast data and upload software updates via internet; remote control roasting via laptop, tablet or smart phone
- Fuel: Natural or propane gas
- Roast Time Range: 10 to 16 minutes (typical)
- Safety Features: Self-cleaning roast chamber and exhaust stack; water quench into cyclone and chaff barrel
- Rugged stainless steel construction, superior motors, drives and controls throughout for low maintenance and long life
- Automatic green drop and auto-discharge door standard with manual override switch
- Automatic green bean vacuum loader with green dust collection system
- Footprint: 37.9 ft² (3.5 m²)
(91" deep x 60" wide/230 cm x 152 cm)



Technical Specifications

Maximum Batch Size	33 lb (15 kg)
Minimum Batch Size	6.6 lb (3 kg)
Nominal Electrical Power	2.8 kW
Peak Electrical Power	5.8 kW
Maximum BTU Rating	130,000 BTU/h (33,000 kcal/h)
Stack Rated Temperature	1,400 °F (760°C)
Stack Max Rated Temp (intermittent).....	1,500 °F (816°C)
Stack Max Flow	22 dscfm (37 dsm ³ /h)
Stack Max Flow (Peak Air Cool).....	310 dscfm (527 dsm ³ /h)
Stack Duct Diameter (Minimum)*.....	6 in (152 mm)

Stack Duct Wall Type: Positive Pressure System with
316 Stainless Steel Liner Recommended

Cooler Vent Max Flow	980 scfm (1,665 sm ³ /h)
Cooler Duct Diameter	6 in (152 mm)
Water Supply	1 GPM (4 LPM)
Water Pressure	50 psi (345 kPa)
Compressed Air Flow	4 CFM (0.1 m ³ /min)
Compressed Air Pressure	60 psi (414 kPa)
Natural Gas Pressure	4-7 in WC (1.0-1.7 kPa)
Propane Gas Pressure.....	11-13 in WC (2.7-3.2 kPa)
Weight	1,500 lb (680 kg)

*Larger stack diameters may be required based upon stack geometry

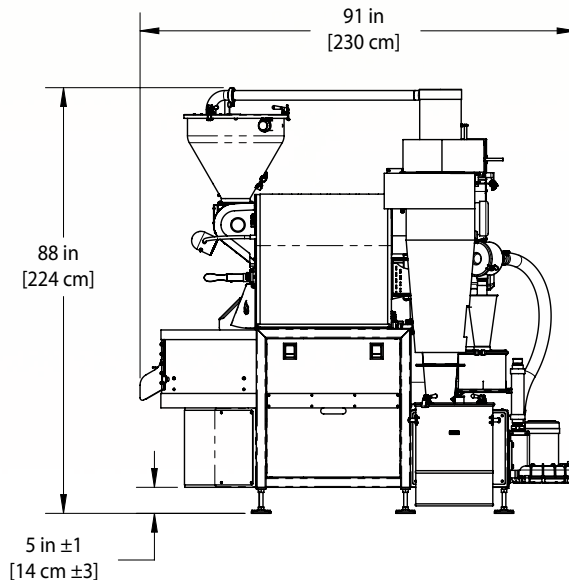
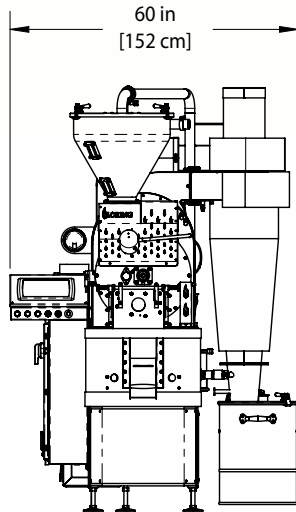
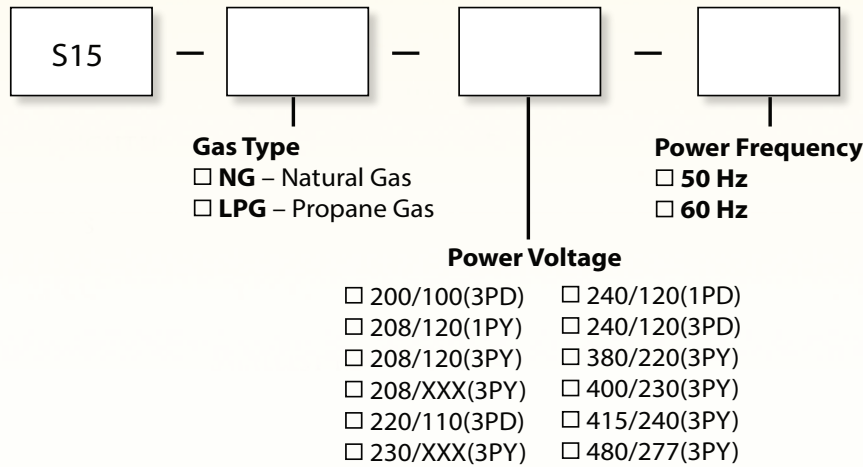

Contact Us Today to Experience a Test Roast on a Loring Roaster

INFO@LORING.COM